

P E R M I T

CITY OF NAPOLEON  
255 W. RIVERVIEW AVE  
NAPOLEON, OHIO 43545

DIVISION OF BUILDING & ZONING  
PH (419) 592-4010  
FAX (419) 599-8393

PERMIT NO: 98321

DATE ISSUED: 09-21-98

ISSUED BY: BND

JOB LOCATION: 845 VOCKE ST

EST. COST:

LOT #:

SUBDIVISION NAME:

OWNER: MOCK/BUEHRER  
ADDRESS: 1227 DODD ST  
CSZ: NAPOLEON, OH 43545  
PHONE: 419-592-0825

AGENT: MOCK BUEHRER BUILDER  
ADDRESS: P-707 CO RD 16  
CSZ: NAPOLEON, OH 43545  
PHONE: 419-592-0825

USE TYPE - RESIDENTIAL:

OTHER:

ZONING INFORMATION

DIST: LOT DIM: AREA: FYRD: SYRD: RYRD:  
MAX HT: # PKG SPACES: # LOADING SP: MAX LOT COV:

BOARD OF ZONING APPEALS:

WORK TYPE - NEW: REPLMNT: ADD'N: ALTER: REMODEL:

WORK INFORMATION

SIZE - LGTH: WIDTH: STORIES: LIVING AREA SF:  
GARAGE AREA SF: HEIGHT: BLDG VOL DEMO PERMIT:

WORK DESCRIPTION

WATER TAP NEW BUILDING

FEE DESCRIPTION

PAID DATE

FEE AMOUNT DUE

WATER TAP PERMIT

650.00

TOTAL FEES DUE

650.00

DATE

APPLICANT SIGNATURE

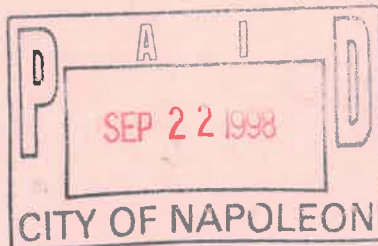

CITY OF NAPOLEON

WATER METER YOKE RELEASE FORM

THIS DOCUMENT ENTITLES THE HOLDER TO "ONE" WATER METER YOKE ASSEMBLY  
(Please pickup at City Operations Department 1775 Industrial Drive).

PERMIT #: 98321

ISSUED: 09-21-98

JOB LOCATION: 845 VOCKE ST

OWNER: MOCK/BUEHRER

PHONE: 419-592-0825

ADDRESS: 1227 DODD ST NAPOLEON, OH 43545

-----  
CONTRACTOR: MOCK BUEHRER BUILDERS

ADDRESS: P-707 CO RD 16 NAPOLEON, OH 43545

PHONE: 419-592-0825

WATER TAP SIZE 1"  1.5" \_\_\_\_\_ 2" \_\_\_\_\_ OTHER \_\_\_\_\_

WATER METER YOKE SIZE 5/8"  3/4" \_\_\_\_\_ 1" \_\_\_\_\_ OTHER \_\_\_\_\_

NEW STRUCTURE  EXISTING STRUCTURE \_\_\_\_\_ LAWN METER \_\_\_\_\_

WATER SERVICE LINE TO BE TYPE "K" COPPER OR "CTS" POLYETHELENE TUBING  
OF 1" MINIMUM SIZE.

BACKFLOW DEVICE REQUIRED YES  NO \_\_\_\_\_

TYPE OF BACKFLOW DEVICE REQUIRED Double check valve  
assembly.

WATER METER YOKE INSTALLATION IS SUBJECT TO THE FOLLOWING CONDITIONS

- 1.) MUST BE LOCATED IN AN ACCESSIBLE AREA.
- 2.) MUST BE IN AN AREA WHICH IS NOT SUBJECT TO FREEZING TEMPERATURES.
- 3.) MUST BE AT LEAST 18" ABOVE FLOOR LEVEL (NO CRAWL SPACE INSTALLATIONS).
- 4.) MUST COMPLY WITH MINIMUM MOUNTING REQUIREMENTS (DRAWING AVAILABLE)

ISSUED BY \_\_\_\_\_ RECEIVED BY \_\_\_\_\_

1-Copy to: Building Dept, Water Dept, and Utilities Dept

CITY OF NAPOLEON

WATER METER YOKE RELEASE FORM

THIS DOCUMENT ENTITLES THE HOLDER TO "ONE" WATER METER YOKE ASSEMBLY  
(Please pickup at City Operations Department 1775 Industrial Drive).

PERMIT #: 98321

ISSUED: 09-21-98

JOB LOCATION: 845 VOCKE ST

OWNER: MOCK/BUEHRER

PHONE: 419-592-0825

ADDRESS: 1227 DODD ST NAPOLEON, OH 43545

-----  
CONTRACTOR: MOCK BUEHRER BUILDERS

ADDRESS: P-707 CO RD 16 NAPOLEON, OH 43545

PHONE: 419-592-0825

WATER TAP SIZE 1"  1.5" \_\_\_\_\_ 2" \_\_\_\_\_ OTHER \_\_\_\_\_

WATER METER YOKE SIZE 5/8"  3/4" \_\_\_\_\_ 1" \_\_\_\_\_ OTHER \_\_\_\_\_

NEW STRUCTURE  EXISTING STRUCTURE \_\_\_\_\_ LAWN METER \_\_\_\_\_

WATER SERVICE LINE TO BE TYPE "K" COPPER OR "CTS" POLYETHELENE TUBING  
OF 1" MINIMUM SIZE.

BACKFLOW DEVICE REQUIRED YES  NO \_\_\_\_\_

TYPE OF BACKFLOW DEVICE REQUIRED Double check valve  
assembly.

WATER METER YOKE INSTALLATION IS SUBJECT TO THE FOLLOWING CONDITIONS

- 1.) MUST BE LOCATED IN AN ACCESSIBLE AREA.
- 2.) MUST BE IN AN AREA WHICH IS NOT SUBJECT TO FREEZING TEMPERATURES.
- 3.) MUST BE AT LEAST 18" ABOVE FLOOR LEVEL (NO CRAWL SPACE INSTALLATIONS).
- 4.) MUST COMPLY WITH MINIMUM MOUNTING REQUIREMENTS (DRAWING AVAILABLE)

ISSUED BY \_\_\_\_\_ RECEIVED BY \_\_\_\_\_

1-Copy to: Building Dept, Water Dept, and Utilities Dept



CITY OF NAPOLEON WATER TAPPING PERMIT FORM

PERMIT #: 98321

ISSUED:

JOB LOCATION: 845 Vocke

SUBDIVISION NAME: \_\_\_\_\_ LOT #: \_\_\_\_\_

OWNER: Mock/Bucher

ADDRESS: 1227 Dodd Napoleon, Ohio

CONTRACTOR: Mock Bucher Bldgs.

PHONE: 592-0825

TAP SIZE: 1" X 1.5" \_\_\_\_\_ 2" \_\_\_\_\_ OTHER \_\_\_\_\_

AMOUNT PAID: \$650.00 YOKE SIZE: 5/8"

PLUMBING CONTRACTOR: \_\_\_\_\_ PH: \_\_\_\_\_

DATE OF TAP: 4-5-99 OLD TAP #: \_\_\_\_\_ NEW TAP #: 9912

SIZE AND KIND OF MAIN: 10" C.I.P.

LOCATION OF MAIN: 25' EAST of store lot DEPTH OF MAIN: 4 1/2'

DIST FROM HYDRANT\VALVE: 15' N of V#222 DIST TO CURB STOP FROM CORP: 16'

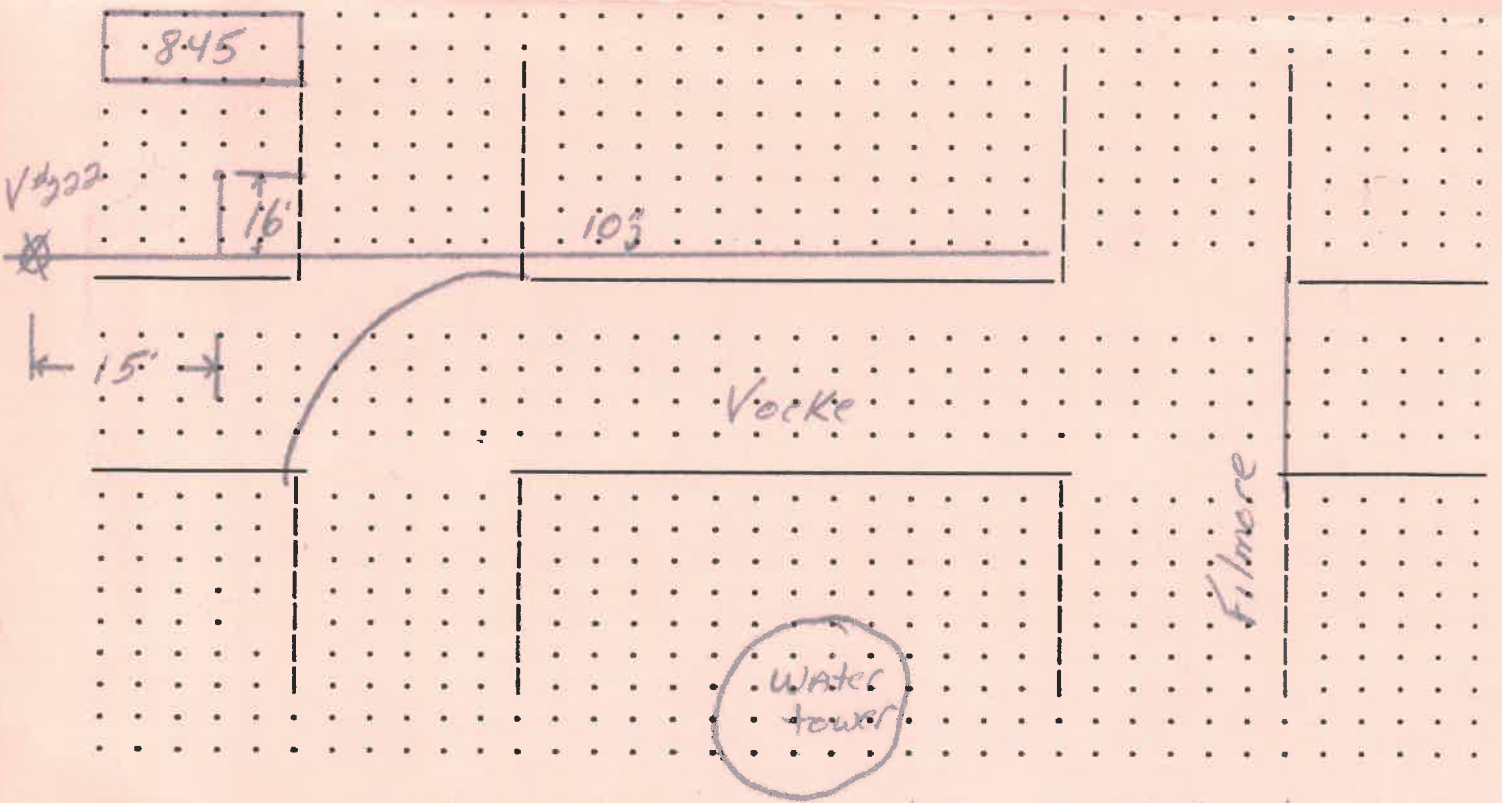

DATE APPROVED: Oct 28, 1999

BY: Jeffrey E. Mantel

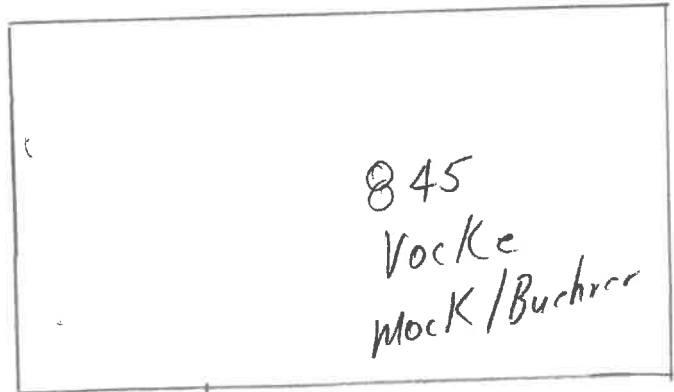

← 31.5'

4" SDR35  
san Catch basin

6" tee  
@ 3.8'

35'  
31.5'  
4" SDR35  
55.2'

88.6'

6" 45°  
@ 4' F/L  
6" 220 cell

6" from building  
sanitary @ F/L

6X8  
ferroco

8" vit to water  
tower drain  
@ F/L

65'

Bolt

Wassertower

